



Property found on boxpod.co.uk
Quote Reference: **Boxpod**



International Workplace Group



Signature
by Regus

No18

regus.com
spacesworks.com

DESIGN YOUR OFFICE

DESIGN
YOUR OFFICE





Property found on boxpod.co.uk
Quote Reference: **Boxpod**

LET'S CREATE A GREAT DAY AT WORK

TABLE OF CONTENTS

P04 LET'S CREATE A GREAT DAY AT WORK

P06 DESIGN YOUR OFFICE

P12 SELECT YOUR DESK SPACE

P14 SELECT YOUR ACCESSORIES

P22 SELECT YOUR OFFICE ENHANCEMENTS

P26 DESIGN IDEAS

P48 FURNITURE LIBRARY

Your workplace needs to address the diverse

Pick the desk set up that has the right balance



Property found on boxpod.co.uk
Quote Reference: **Boxpod**

*Let's create
a great day
at work*

Tell us about your typical work week
and how you want your team to work.



Membership

Members can work at any of our centres worldwide. Choose from lounge, coworking or office accommodation and 5-day, 10-day or unlimited monthly access.



Virtual Office *

Virtual Office provides a business address, phone number, receptionist service and office days for customers who normally work at home or outside a traditional office environment.



Coworking

Our coworking spaces offer an attractive shared environment for flexible working, collaboration and ideation.



Private, dedicated offices

Private offices give you control over exactly how you work every day. We give you the opportunity to Design Your Office, tailoring your workspace to match your exact needs.



Flexible Agreements

Tailored, flexible agreements to match your needs. All the time, every time.



Access your account, book space and



Property found on boxpod.co.uk
Quote Reference: Boxpod

DESIGN YOUR OFFICE



Photo courtesy of steelcase

With IWG, you can create a room to satisfy all the demands on your workplace. Clients value designing their office with IWG because they can achieve a much better, more tailored use of their space:

Efficient and effective designs.

Ergonomic, high quality furniture.

Configurability and flexibility for different work styles.

HOW DOES IT WORK?

- 1 Tell us what you need to have a great day at work.
- 2 Select your desk type, desk accessories and chair.
- 3 Decide whether you want to work in a team, executive or spacious executive environment.
- 4 Pick your office enhancements.
- 5 Begin your great day at work!

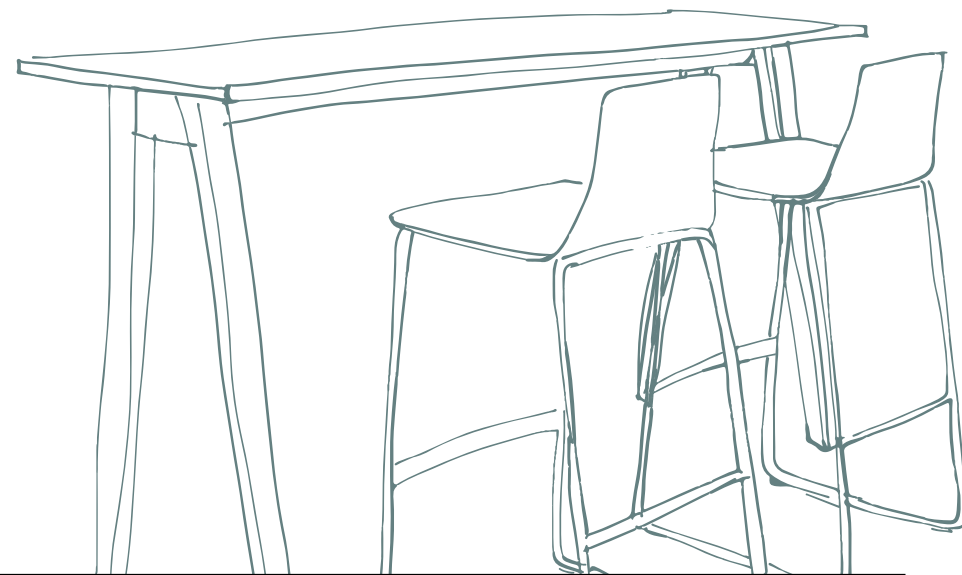



Property found on boxpod.co.uk
Quote Reference: Boxpod

LET'S GET STARTED

Tell us what you need to have a great day at work.

WORK STYLE

How does your team work? What is important – large work area or space efficiency? Quiet work or working together?

COLLABORATION

What types of collaboration do you have with each other? Meetings, brainstorming, sharing content. What kind of content, analogue or digital? Are these collaborations planned or impromptu?

HOSTING

Do you like to host clients or outside visitors in your space? What about visiting employees?

STORAGE

What are the materials your team needs to keep in their space every day? How much storage does each person need? How much does the organisation need?

PRIVACY

Will there be activities or meetings that will need complete privacy from the rest of the team?

WELLBEING AND ERGONOMICS

How might different postures (standing, lounge, or seated) enhance your great day at work? What other aspects of wellbeing are important to your organisation?

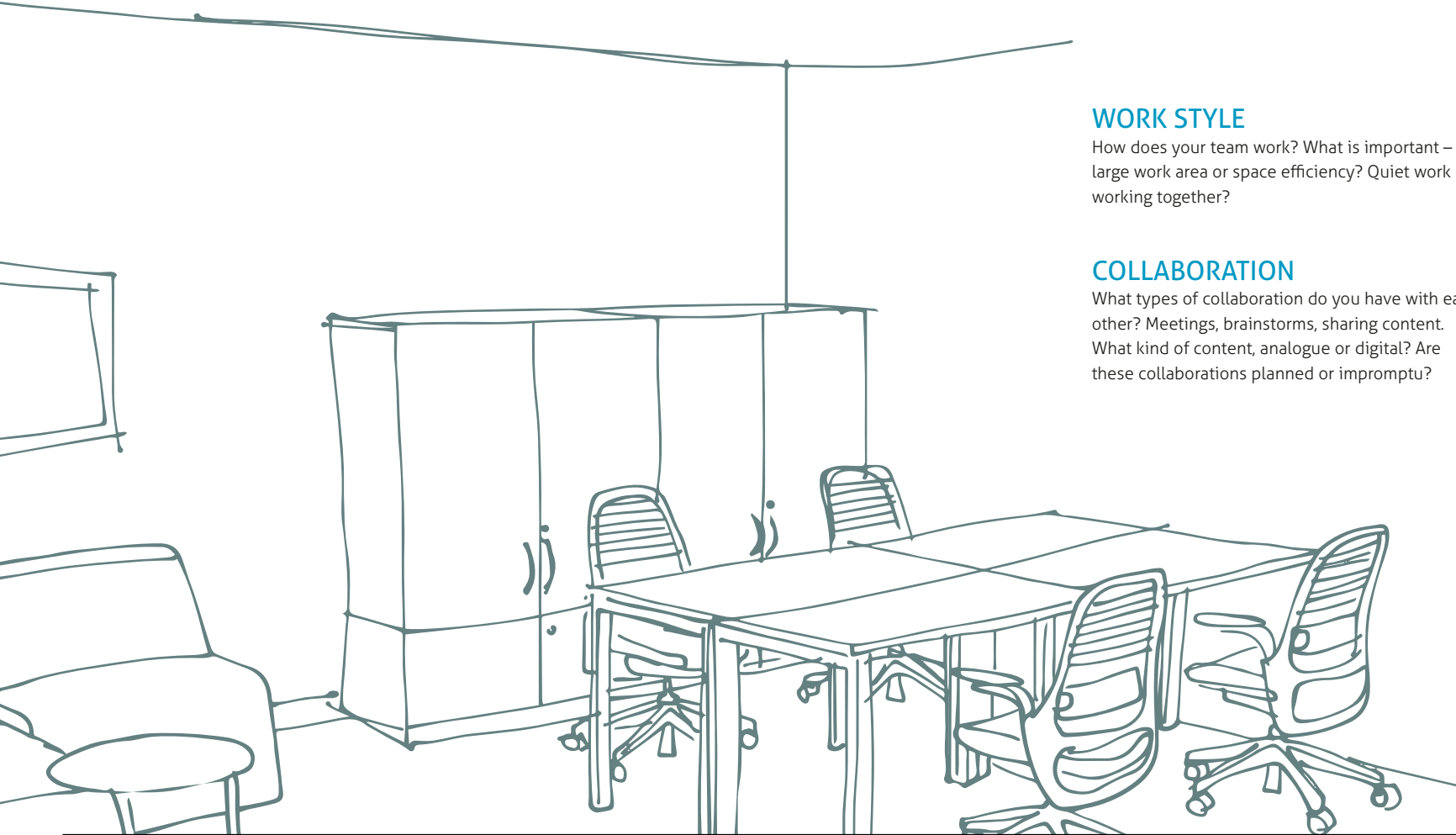



Property found on boxpod.co.uk
Quote Reference: Boxpod

Wellbeing at work – to have the brain fully firing, the body needs to be supported and comfortable.

Research shows that changing postures is physically energising, mentally stimulating and helps people stay refreshed and engaged. All adding up to a great day at work....





Property found on boxpod.co.uk
Quote Reference: **Boxpod**

Desk types

We offer two types of desk in many sizes.



Fixed Desk

Designed to support users with a seated height of 730 mm and with 80 mm of height adjustability.



Electric Sit to Stand Desk *

Designed to support users to sit or stand from 720 mm to 1200 mm height. Electric and user adjustable at the push of a button.

Team Desks

1000x600 mm



1200x600 mm



Executive Desks

1400x800 mm



1600x800 mm



Team Desks

1200x600 mm



Executive Desks

1400x800 mm



1600x800 mm





Property found on boxpod.co.uk
Quote Reference: Boxpod

Desk accessories

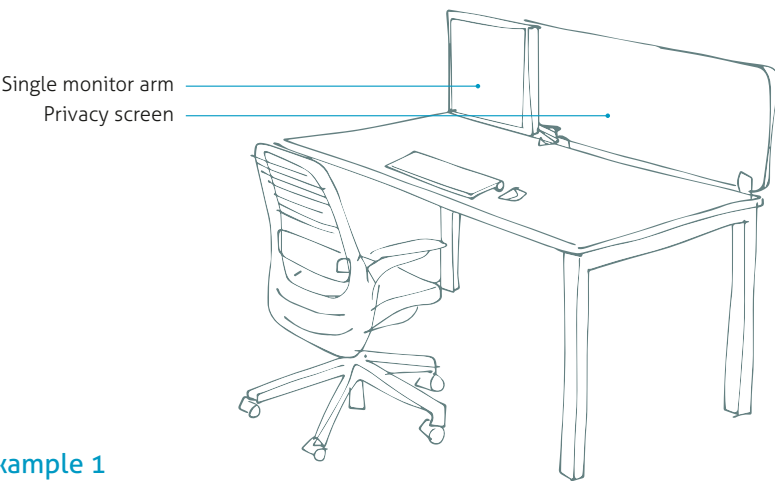

Example 1
Individual desk

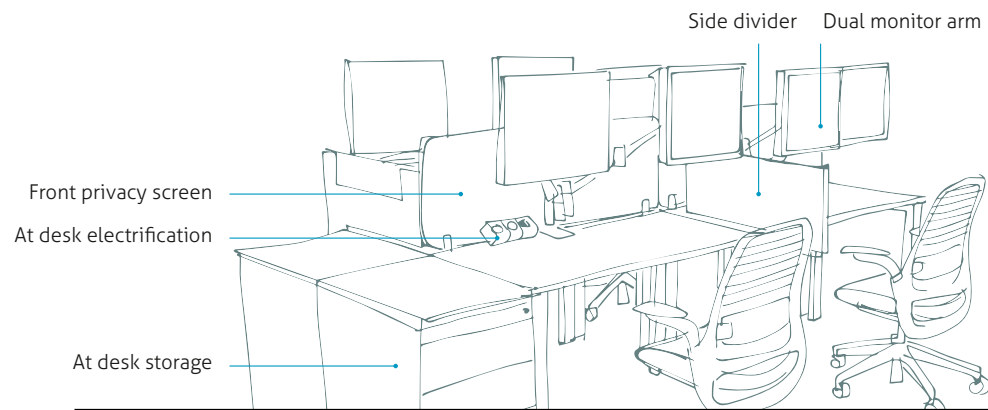

Front privacy screen *



Modesty panel for under desk
privacy *



Side screen *



Electrification on desk with 2
power and 1 data point *



Single or dual monitor arms *



Select your chair

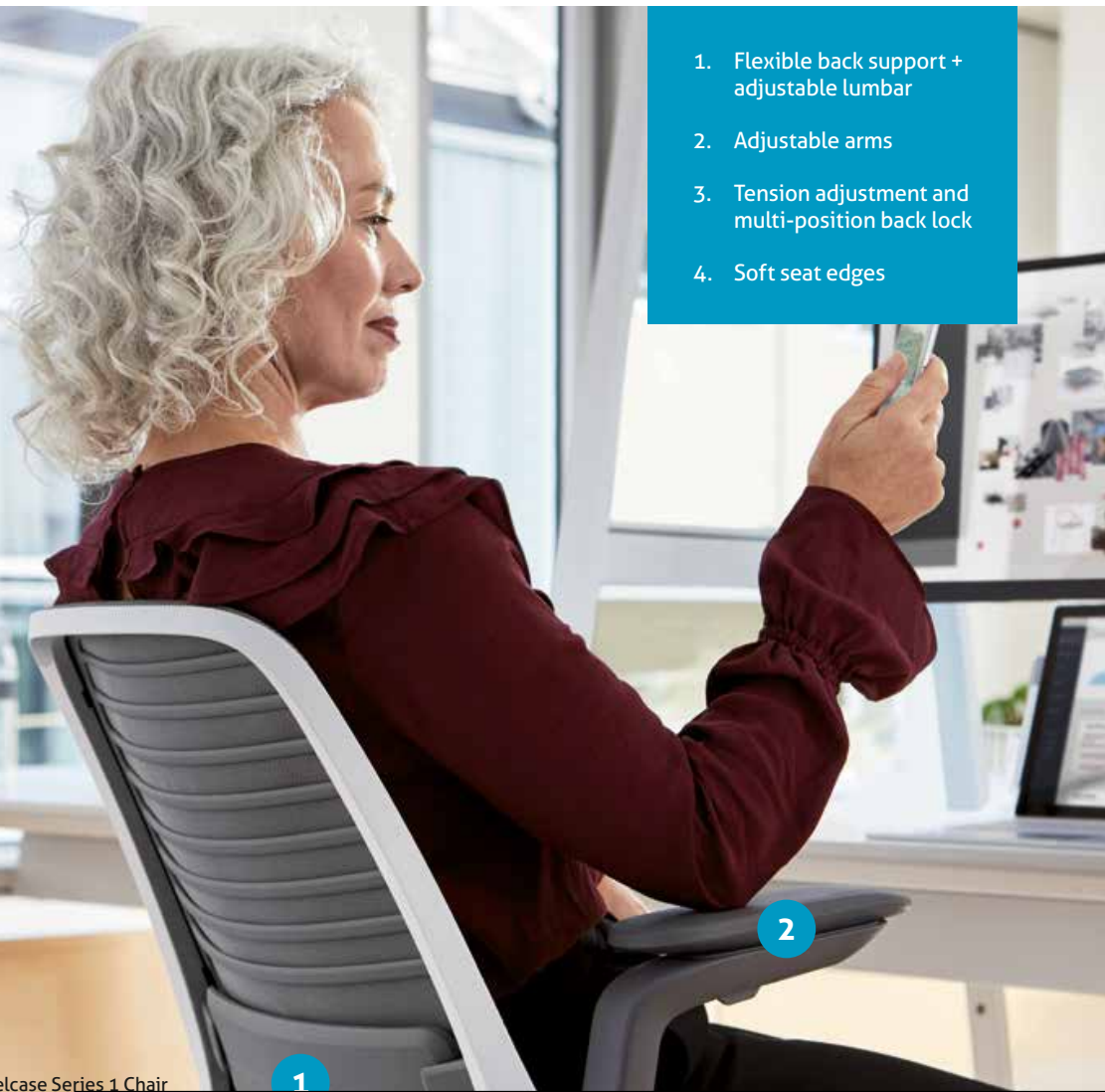

1. Flexible back support + adjustable lumbar
2. Adjustable arms
3. Tension adjustment and multi-position back lock
4. Soft seat edges

With a third of your time spent at work, a high performing chair shouldn't just be a luxury.



Task Chair

Mesh back chair with height adjustable arms and adjustable seat height.



Series 1 *

Premium mesh back chair with a weight activated mechanism, height adjustable arms, adjustable seat height, adjustable lumbar.



Series 1 with Headrest *

Premium mesh back chair with a weight activated mechanism, height adjustable arms, adjustable seat height, adjustable lumbar.

A chair needs to fit to you and not you to the chair. By providing intuitive or automatic adjustments, people will feel encouraged



Property found on boxpod.co.uk
Quote Reference: Boxpod

Desk space

Choose the right desk density for you and your team.

TEAM ROOM

Team rooms are space efficient and cost-effective. They use compact settings to minimise wasted space while accommodating your team with the form and function needed to work well.

Desk Dimensions:

1,000x600 mm

1,200x600 mm



EXECUTIVE

Looking for something with a little more room? Our executive settings give you a greater workspace and bigger work area.

Desk Dimensions:

1,400x800 mm

1,600x800 mm



SPACIOUS EXECUTIVE

You can easily create a space with ample room for individuals to spread out, focus and collaborate with each other by selecting a spacious executive room. These rooms give you the ability to design a larger ecosystem for your organisation.





Property found on boxpod.co.uk

Quote Reference: Boxpod



Design your office for maximum effectiveness. Make the most of your space by adding accessories to enable concentration and organisation.

Desktop screens provide you and your team the ability to create visual privacy and set boundaries between desks.



This Functional Screen provides your team with organisation, boundaries and privacy.



Property found on boxpod.co.uk

Quote Reference: Boxpod

Office enhancements

Enhance your office with furniture settings that improve effectiveness, efficiency and comfort. What do you and your team need to have a great day at work?



Media Meeting *

This setting serves multiple purposes: simple face-to-face meetings; presenting and sharing content on the screen; and additional workspace for visiting colleagues or guests.

In this standing-height setting, you can choose to sit on a high chair or stand as you meet and discuss with colleagues, customers or suppliers.

Stand + Meet



Informal Meeting

An informal meeting space offers teams the ability to socialise, meet and create away from the desk. Chairs can easily be added or removed.



The Be Free

These soft chairs are perfect for reconfiguring and are easy to move. A great setting for an informal conversation or hosting a visitor.



Quick Brainstorm

Informal postures foster creativity. These fun seats move with you and are height adjustable.

Bring a softer feeling into your space by including this sofa set and coffee table. The setting is perfect for hosting guests, socialising, and informal meetings.

The Lounge Collection



Share + Display *

A hard working setting that brings together digital content sharing with places for teams to store and display important information.

Tall and easily accessible storage works well against a wall with options to be either opened or closed.

Storage Wall





Property found on boxpod.co.uk
Quote Reference: **Boxpod**





Property found on boxpod.co.uk
Quote Reference: Boxpod

Design ideas

We've designed some offices for you.
Let these ideas inspire you as you
design your own.



TEAM ROOM

Idea 1 – Office for Twelve

This efficient and compact set-up works well
for customers needing a simple, cost-effective
workspace solution.

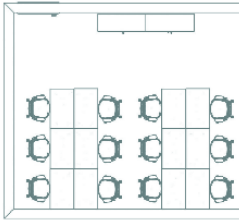

Workspace

Task chair and 1000x600 mm desk.

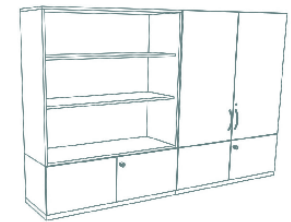

Storage wall

Bookshelf and tall storage.

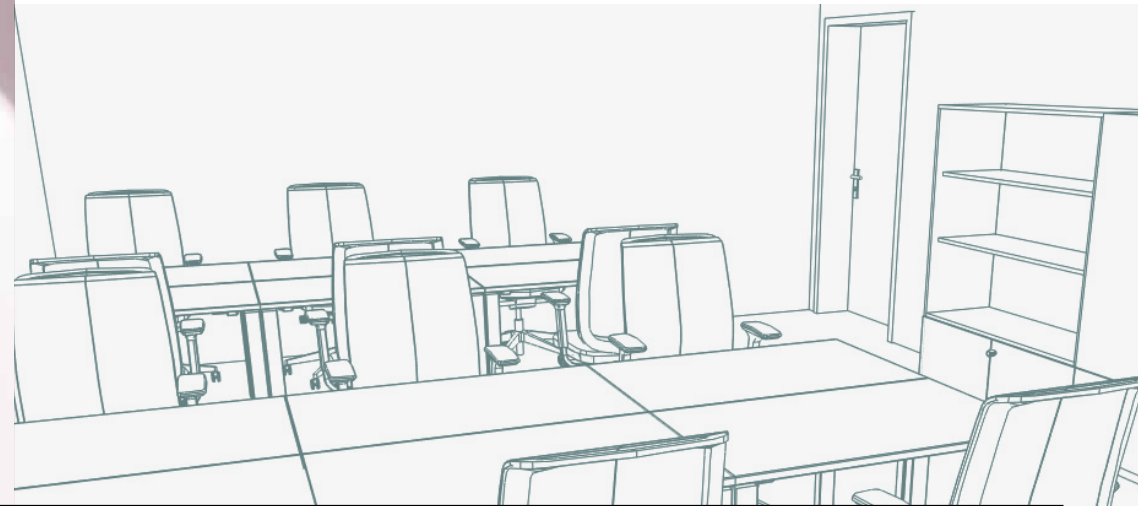



Property found on boxpod.co.uk

Quote Reference: Boxpod

TEAM ROOM

Idea 2 – Office for Four

In this space for four, the team mostly work at their desks, but have soft seating in the corner for informal discussion; to host guests and take a break away from the formal setting of their desks.

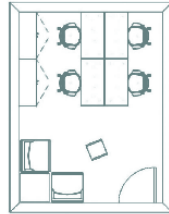

Workspace

1200x600 mm desk, task chair.

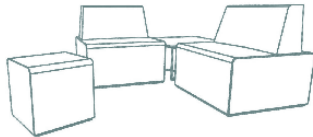

The Be Free

Lounge chair, corner table, small cube.



Storage Wall

Two tall storage units.

TEAM ROOM

Idea 3 – Office for Four

With storage and power directly at their desks, this team has access to all their necessities from their seat. A meeting table allows for digital content sharing and additional seats for guests.

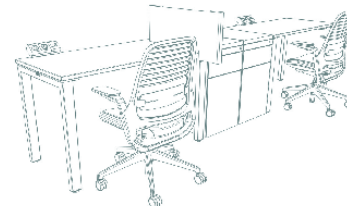

Workspace

1200x600 mm desk, at desk storage, power, side screen.



Media Meeting

Side chairs and media unit with table.

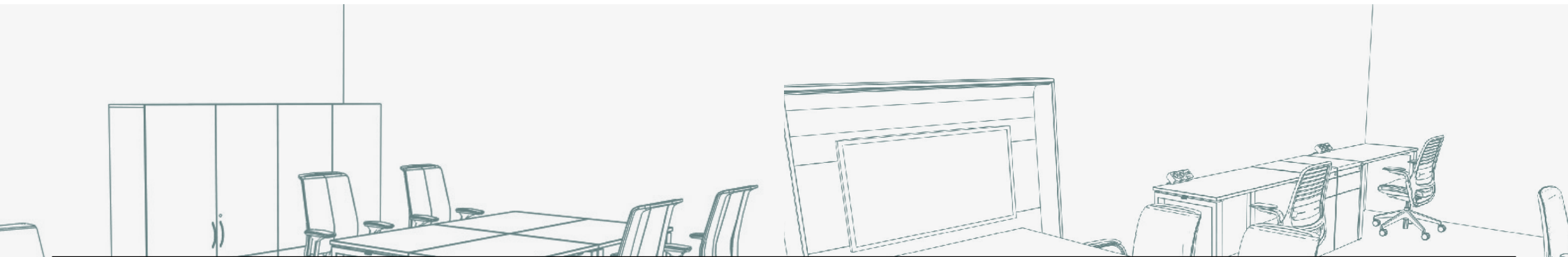



Property found on boxpod.co.uk
Quote Reference: **Boxpod**

Multiple storage options will give you and your team the organisation they need.

Consider how storage can not only add to individual desks but also be used in-between team areas to structure your overall space.

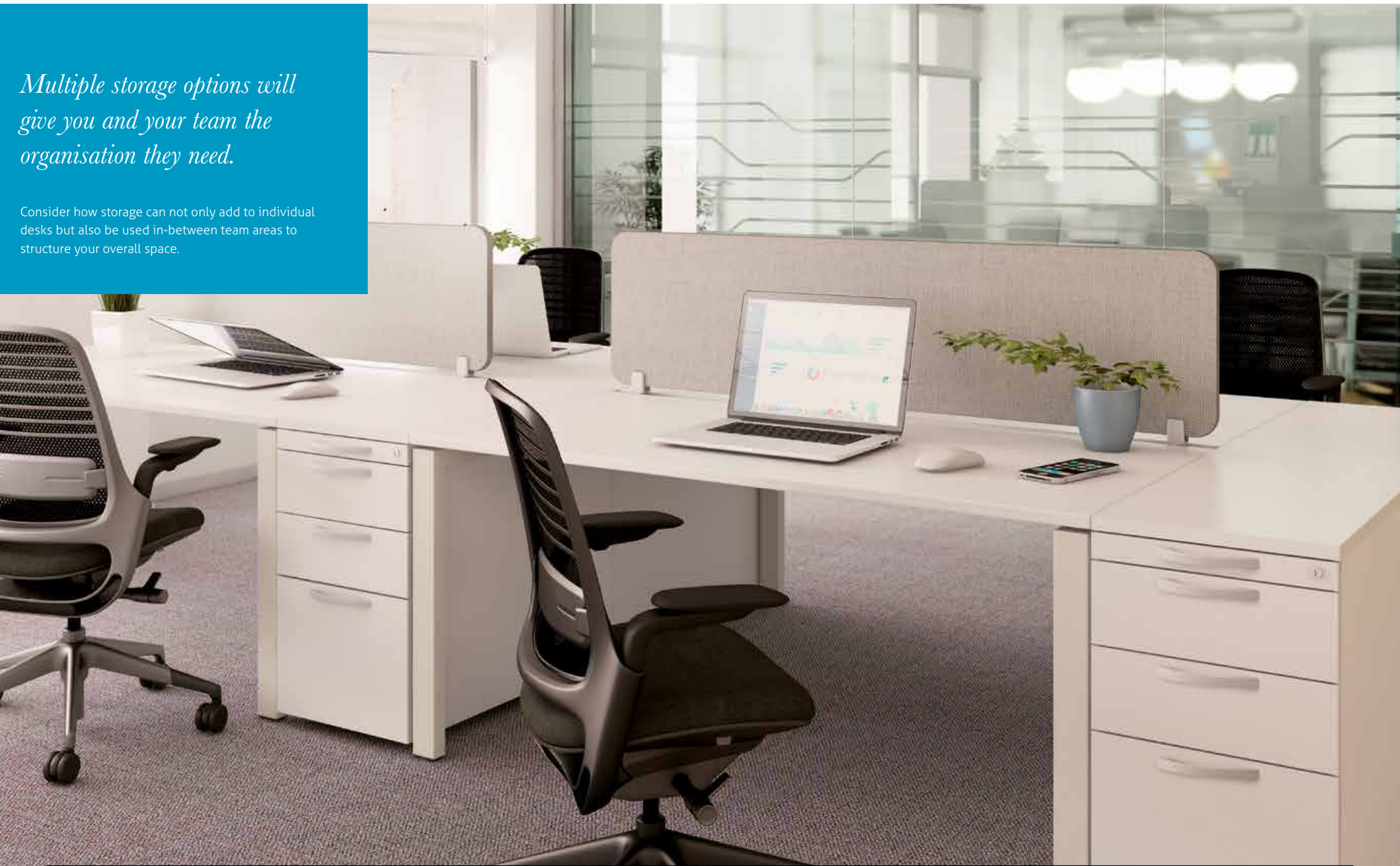



Property found on boxpod.co.uk

Quote Reference: Boxpod

EXECUTIVE SPACE

Idea 4 – Office for Four

This office has larger desks and more circulation space. The space is highly collaborative, with options for soft seating and a standing table for meetings and discussions. When sitting at their desks, the small, mobile stool allows for easy, informal collaboration with a colleague.

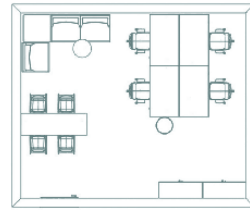

Workspace

Height adjustable desk
1600x800 mm with a
mobile pouffe.



The Be Free

Lounge chair, corner
table, side table.



Stand + Meet

High table and stools.

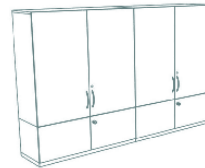

Storage Wall

Two tall storage units.

EXECUTIVE SPACE

Idea 5 – Office for Two

In this room for two, the team can work side by side at their desks, which are height adjustable, to allow for work standing up or sitting down. The soft seating and media unit are great for meetings and for sharing content on a screen.

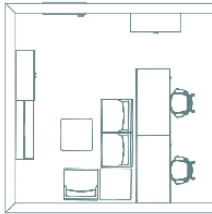

Height Adjustable Desks

Height adjustable desk
1600 x 800 mm.

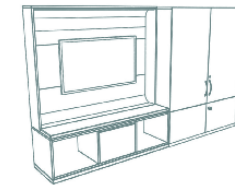

Share + Display

Media unit and tall storage.



The Be Free

Lounge chair and corner table.

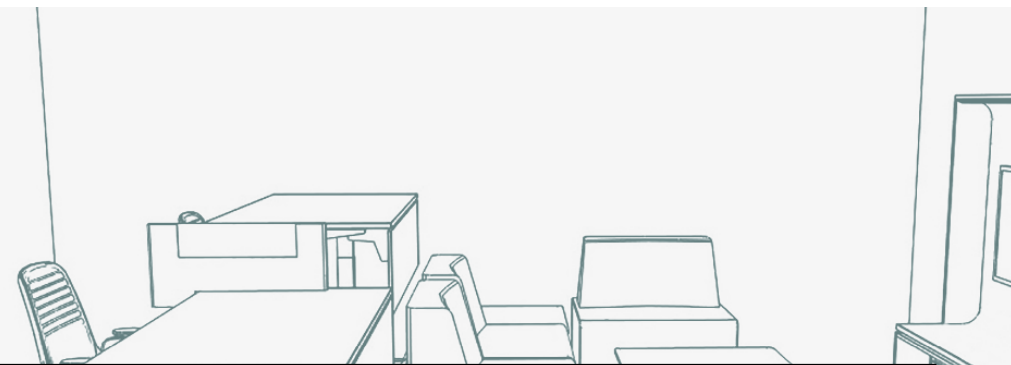
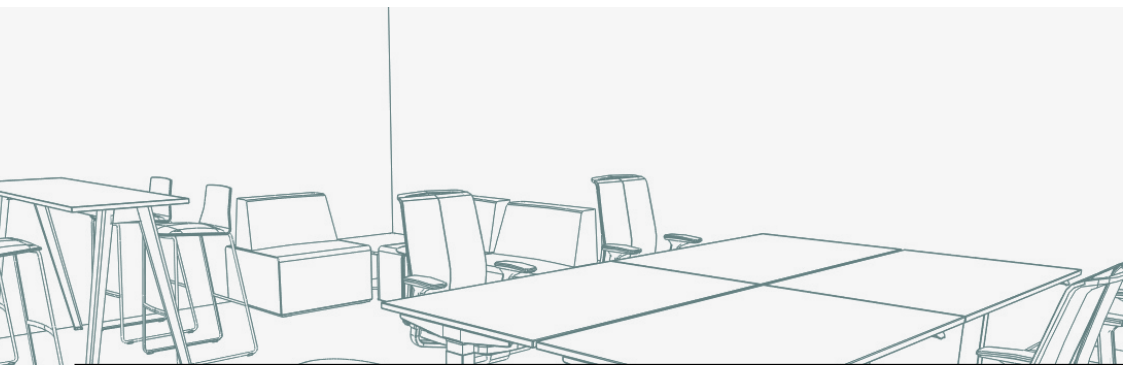



Property found on boxpod.co.uk

Quote Reference: Boxpod

SPACIOUS EXECUTIVE

Idea 6 – Office for One

This office for one boasts an executive 1600x800 mm electric, height adjustable, sit to stand desk with return storage. It also features a generous meeting area for hosting guests and sharing content on a media unit.

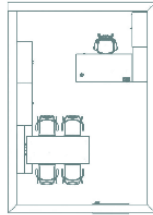

Workspace

Electric, height adjustable desk 1600x800 mm with modesty panel, Series 1 chair with headrest, low storage with cushion top.

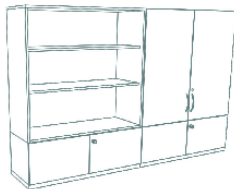

Storage Wall

Bookshelf storage and tall storage.



Media Meeting

Side chair and media unit with table.

SPACIOUS EXECUTIVE

Idea 7 – Office for One

Depending on your business and role, you may prefer to meet with visitors and clients in a comfortable lounge setting. The media unit allows for content sharing and the large desk has a monitor arm and on-desk power for comfort and productivity.

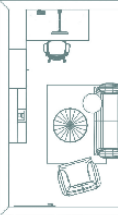

Workspace

1600x800 mm desk, power, monitor arm.

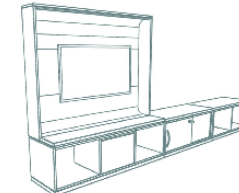

Low Storage + Display

Media unit and low storage with cushion top.

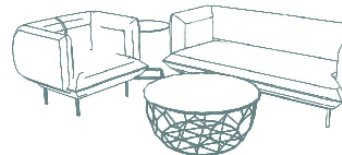

The Lounge Collection

Sofa, armchair, coffee table.





Property found on boxpod.co.uk
Quote Reference: **Boxpod**

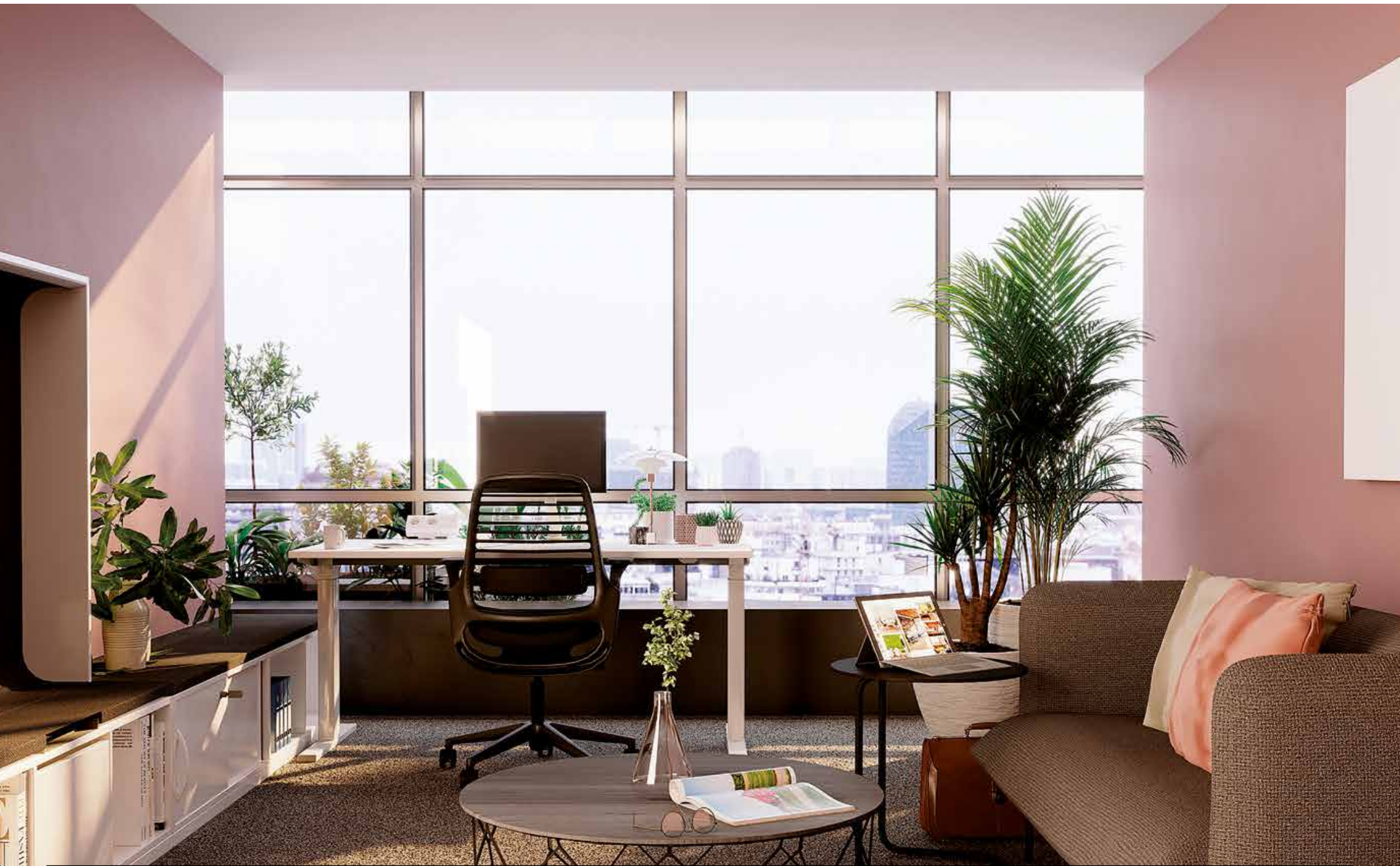



Property found on boxpod.co.uk

Quote Reference: Boxpod

COMBINATION SPACE

Idea 8 – Office for Fourteen

This office comprises a compact team space with two banks of standard sized desks, a manager workspace with larger desks separated from the team for quieter work, and an area for meetings that consists of a meeting table and some informal comfort seating.

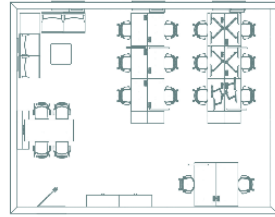

Workspace

1200x600 mm desk, side tambour storage, monitor arms, front privacy screen, side screen.



Manager workspace

1600x800 mm desk, side screen, desk electrification.



The Be Free

Lounge chairs, corner table.



Media Meeting

Side chairs and media unit with table.





Property found on boxpod.co.uk

Quote Reference: Boxpod

By supporting varied postures in your office design, you can enable your team to easily add activity and movement into their day.

The British Journal of Sports Medicine recommends 2 to 4 hours of standing and light activity spread throughout the workday.

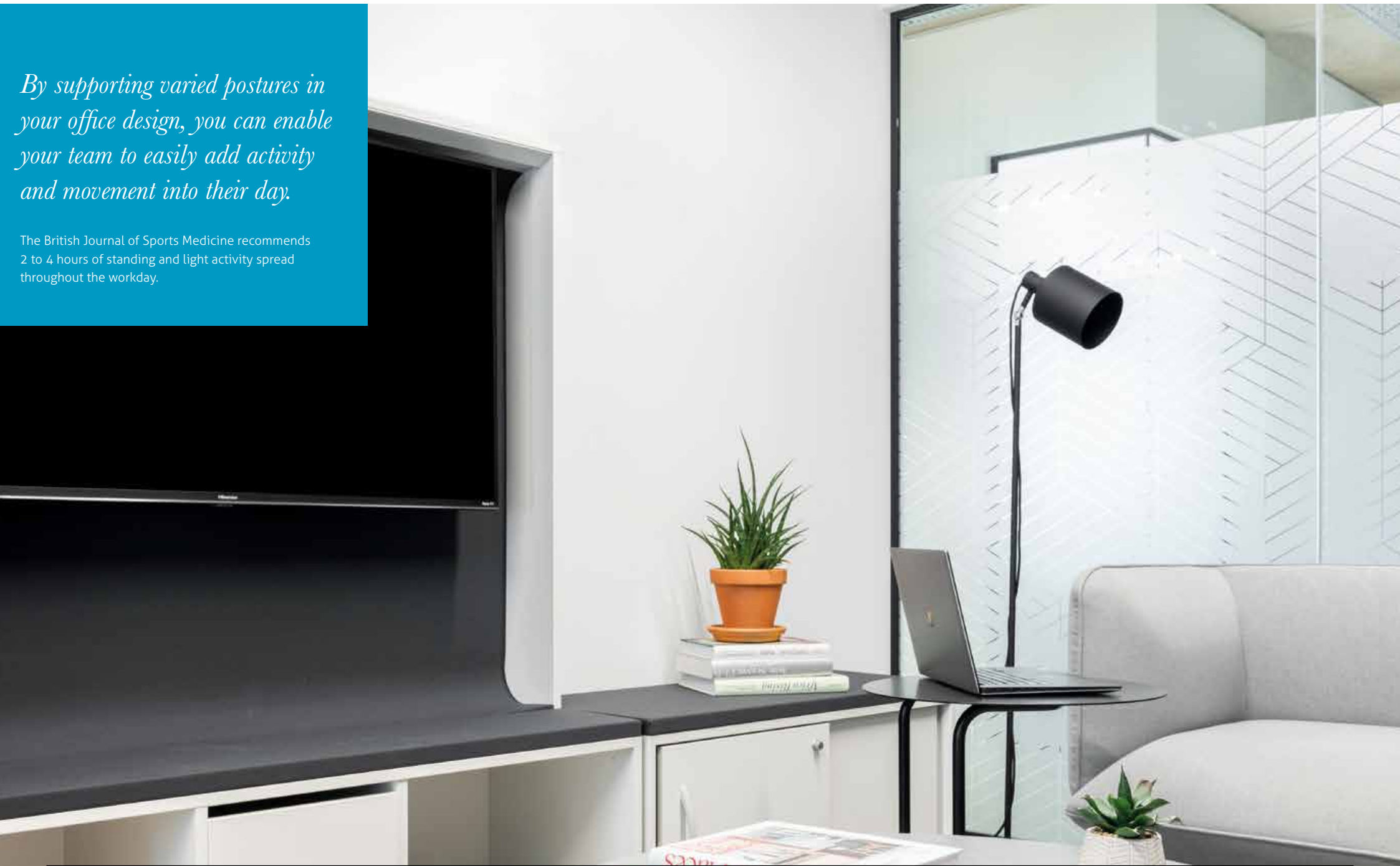



Property found on boxpod.co.uk
Quote Reference: Boxpod

Additional rooms

Many businesses want to include a separate functional room in their office set up: a space separated from their main office in which to handle specific tasks – such as meetings, conference calls, customer waiting and collaboration.



WAITING ROOM

This waiting room offers comfortable seating paired with a media unit to display content while guests relax.

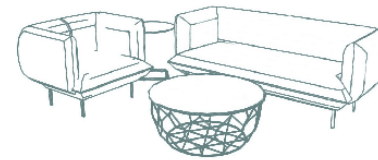
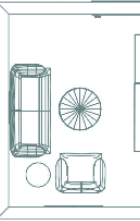

The Lounge Collection

Sofa, armchair, coffee table and side table.

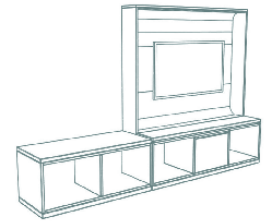

Low Storage + Display

Low storage with cushion, media unit.

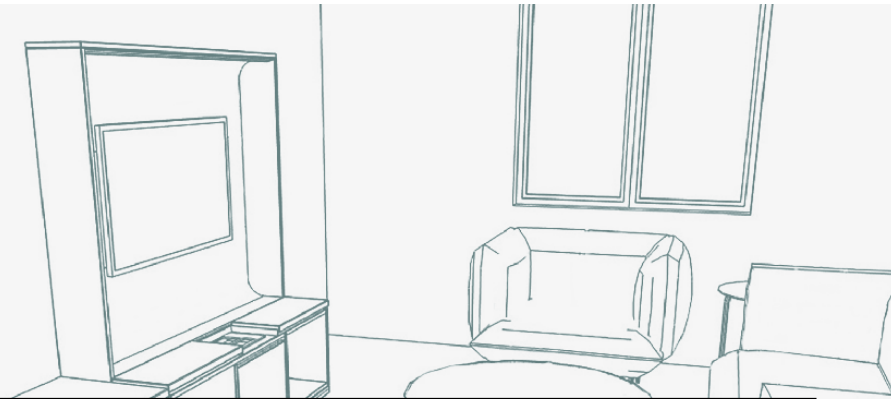



Property found on boxpod.co.uk

Quote Reference: Boxpod

MEETING ROOM

This meeting room is a hard working space with enough space to accommodate six at the table with additional overflow space for visitors on the cushioned low storage. The highly ergonomic chairs can accommodate users meeting for 30 minutes to 8 hours.

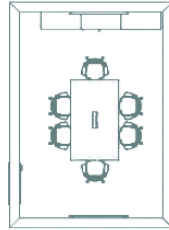

Collaboration

Rectangle meeting table, chair.

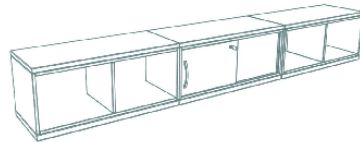

Storage

Low storage with cushion top open shelves, sliding doors.

AGILE STUDIO

Large-scale space supports the multiple stages of creative work. The studio is divided into two zones – one for idea generation and one for informal discussion. Participants can easily switch between the two zones, depending on the type of work that they are doing.

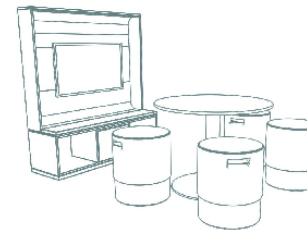
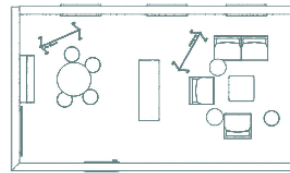

Brainstorm + Display

Round table, Buoy stools, media unit.



Stand up

Standing table.

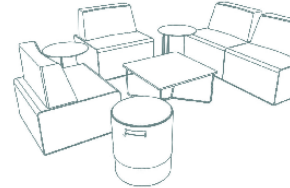

Huddle Together

Lounge chairs, corner table, side table and Buoy stool.

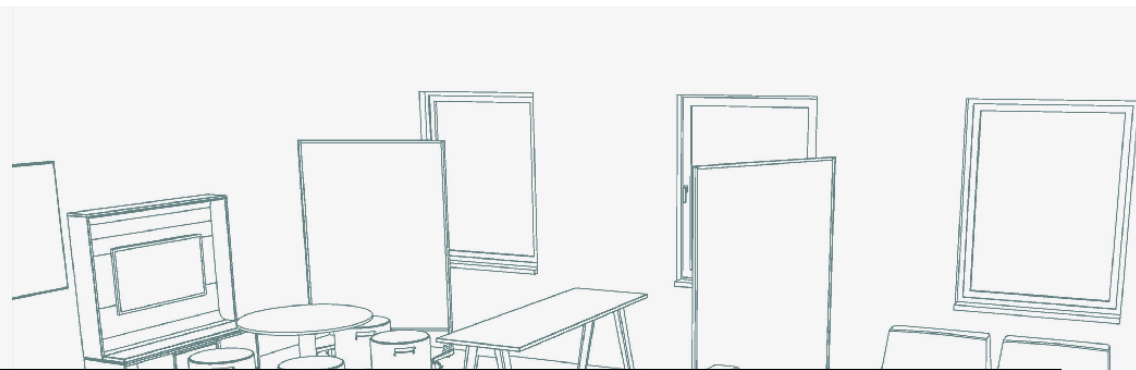
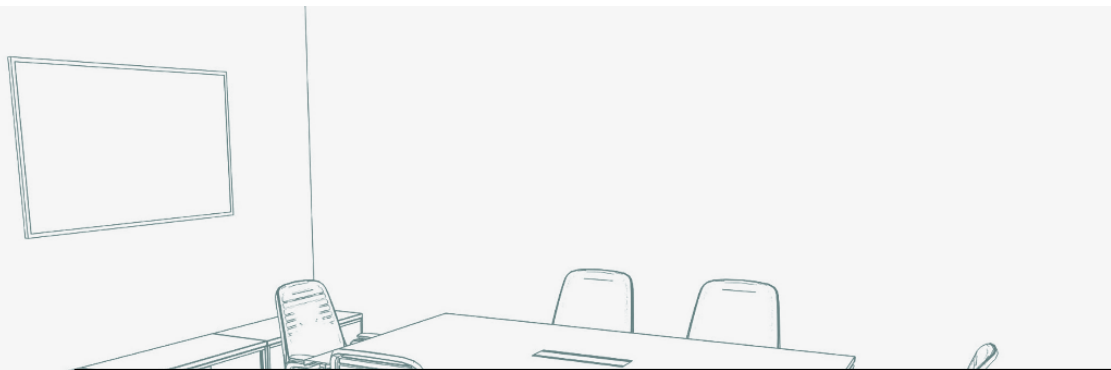



Property found on boxpod.co.uk
Quote Reference: **Boxpod**

Settings that multi-task.

By combining storage for teams and a digital screen for collaboration, this setting is flexible enough for multiple activities: hosting a client, collaborating as a team or supporting project based work.

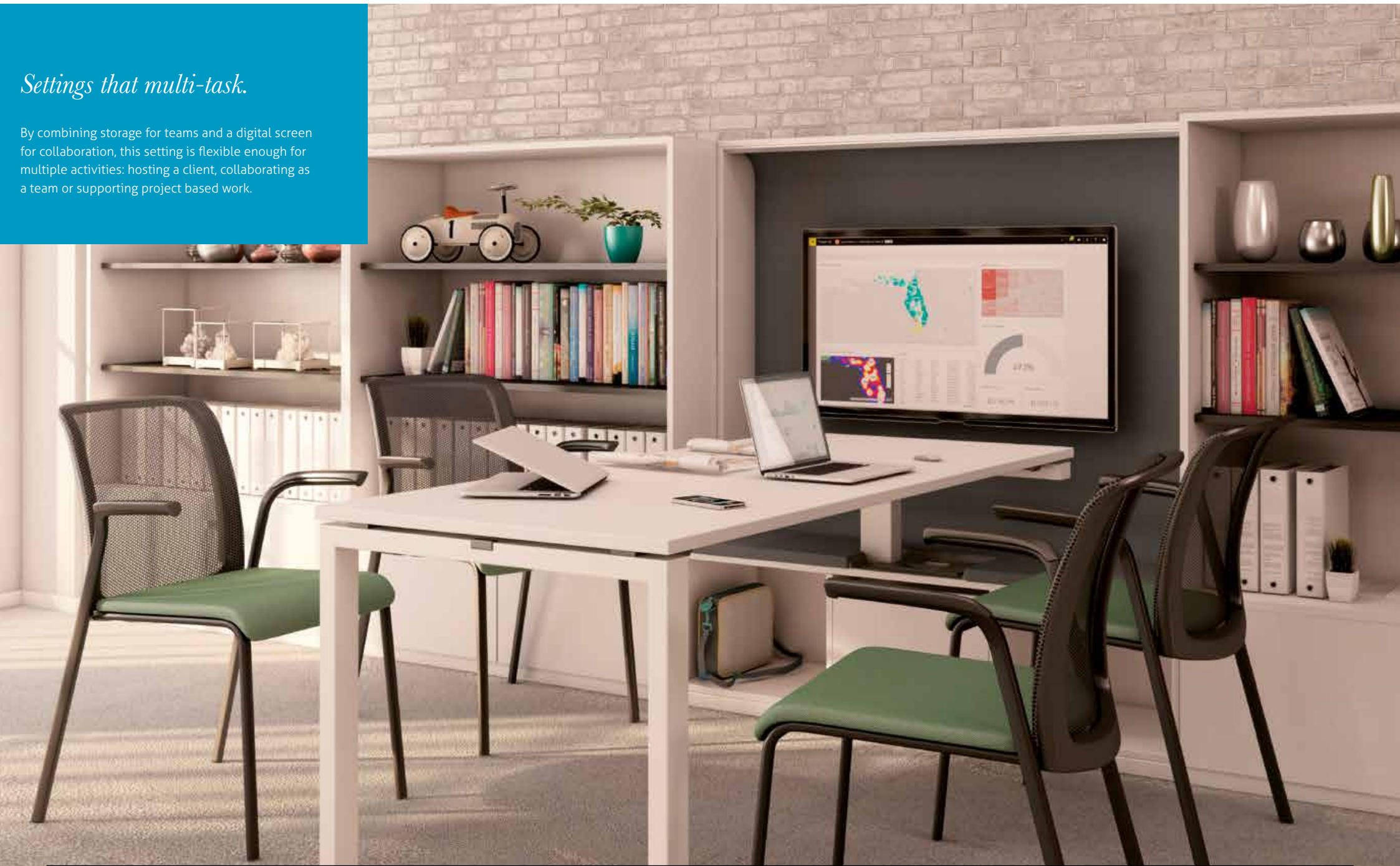



Property found on boxpod.co.uk
Quote Reference: **Boxpod**

Furniture library

All the possibilities in one place.





Property found on boxpod.co.uk

Quote Reference: Boxpod

FURNITURE LIBRARY

DESKS



Fixed Desk

Available in sizes

1200x600 mm,
1400x600 mm,
1600x800 mm,
1600x800 mm

Height
720 mm with 80 mm
adjustment

Finishes

White top, white legs
with small cut-out
middle centred
With 2 cable clips



Electric Sit to Stand Desk ⁽¹⁾

Available in sizes

1200x600 mm, 1400x800 mm, 1600x800 mm

Height

720 mm - 1200 mm user adjustable

Finishes

White top, white legs, with 2 cable clips



Team Bench ⁽¹⁾⁽²⁾

Available in sizes

Person D1600xW2400 mm

Person D1600xW3000 mm

STORAGE



Low Storage with Cushion Top

Dimension

W1000xH415xD434 mm

Finishes

White body, dark grey
cushion top
(Atlantic Pepper)



Low Storage with Cushion Top

Dimension

W1000xH415xD434mm

Sliding door

(left opening), lock

Finishes

White body, silver
handles, dark grey
cushion top
(Atlantic Pepper)



Drawer Storage at Desk

Available in 2 sizes

W419xD600xH725 mm

W419xD800xH725 mm

+5 mm height

adjustment, comes with
one pencil tray and lock

Finishes

White



Mobile Pedestal Under Desk ⁽¹⁾

Dimension

W320xD590xH516 mm

Comes with lock and
castors

Finishes

White



Low Tambour Storage

Available in 2 sizes

W800 x D430 x H725 mm

W600 x D430 x H725 mm



Tall Open Storage

Dimension

W1200 x H1540x D434 mm

Two open shelves, lock, hinged



Tall Closed Storage

Dimension

W1200 x H1540 x D434 mm

Two open shelves inside top unit



Property found on boxpod.co.uk

Quote Reference: Boxpod

FURNITURE LIBRARY

EATING



Desk Chair
Adjustments
Mesh back chair, height adjustable
arms, and adjustable seat height
Finishes
All black



Series 1 ⁽¹⁾
Adjustments
Weight activated mechanism,
height adjustable arms, seat
depth, seat height adjustment of
420 – 546 mm, adjustable lumbar
Finishes
All black



Series 1 with Headrest ⁽¹⁾
Adjustments
Weight activated mechanism,
height adjustable arms, seat
depth, seat height adjustment of
420 – 546 mm, adjustable lumbar
Finishes
All black



Side Chair
Dimension
L450 x D430 x H420 mm
Adjustable 6 units high
Mesh back and upholstered seat



Stool
Dimension
L470 x D490 x H660 mm
Colours
Oak light back, green seat (Remix by Kvadrat, Ivy)

LOUNGE



Cloud Sofa by Bolia
Dimension
W1920 x D820 x H430 mm (2.5 seater)
Finishes
Grey upholstery, black lacquered steel leg
Additional colours made to order ⁽²⁾



Cloud Armchair by Bolia
Dimension
W1020 x D800 x H430 mm (1 seater)
Finishes
Grey upholstery, black lacquered steel leg
Additional colours made to order ⁽²⁾



BeFree Cube Lounge Chair
Dimension
W800 x D750 x H435 mm
Finishes
Seat in blue (Silk Marina) and top
in dark grey (Atlantic Graphite
Pepper) Additional colours made
to order ⁽²⁾



BeFree Small Cube
Dimension
W425 x D425 x H435 mm
Finishes
Green (Remix by Kvadrat, Ivy
Green)



Buoy
Dimension
Diameter 458
Height adjustable from
439 – 578 mm
Finishes
Light blue (Lagoon), Shell,
dark grey upholstered top
(Atlantic Graphite Pepper)





Property found on boxpod.co.uk

Quote Reference: Boxpod

FURNITURE LIBRARY

MEETING



Round Table for 3-4 people
Dimension
Diameter 1000 x H720 mm
Finishes
White top, white base



Rectangle Table
Dimension
W2000 x D1200 x H740 mm
Central power access with 2 power strips, each with 2 power, 2 data
Finishes
White top, white legs



Square Table
Dimension
W1200 x D1200 x H740 mm
Central power access with 2 power, 2 data
Finishes
White top, white legs



Media Meeting Table ⁽³⁾
Dimension
W1800 x D2234 x H1540 mm
Overall. Meeting table is W1800 x D1800 x H740 mm
Includes power strip located in lower storage, TV not included
Finishes
White, inner liner and cushion is dark grey (Atlantic Pepper) White



Media Cabinet ⁽³⁾
Dimension
W1400 x D434 x H1540 mm
Includes power strip located in lower storage, TV not included
Finishes
White, inner liner and cushion is dark grey (Atlantic Pepper)



BeFree Standing Height Table
Dimension
W1800 x D600 x H1000 mm
Finishes
White top, black legs

ACCESSORIES



Divisio Frameless Front Screen ⁽¹⁾⁽²⁾
Available in sizes
W1200, W1400, W1600, W1500 mm
All heights are 405 mm
Finishes
Light grey (Lucia Pearl Grey)



Functional Side Screen ⁽¹⁾⁽²⁾
Clamps to the side of desks
Finishes
White



Modesty Panel ⁽¹⁾⁽²⁾
Available in sizes
W1400 and W1600 mm
Finishes
White



Desktop power ⁽¹⁾
Offers 2 power and 1 data point
Image for reference only.
Product varies per country



Single Monitor Arm ⁽¹⁾⁽²⁾
Clamps to desk



Dual Monitor Arm ⁽¹⁾⁽²⁾
Clamps to desk





Property found on boxpod.co.uk
Quote Reference: **Boxpod**

Express your brand. Express yourself

Organisations need to highlight the brand values that set them apart. We offer you the ability to customise your space to reflect the vibrancy and essence of your brand by:

- Decorating your office walls in a colour of your choice
- Displaying your logo in a prominent place inside your office

Connect to nature

As humans, we seek out connections with nature. Research shows that brains are calmer and more relaxed when natural materials, blues and greens are present in a space. Why not incorporate this into your office? We can help you source the right plants for your space. *

* In participating centres.





Property found on boxpod.co.uk
Quote Reference: **Boxpod**

Movement is good for you

Research shows that activity isn't just good for the body – it's great for the mind, too.

Buoy integrates movement during brainstorming and meetings to boost focus and enhance productivity. With height adjustability and 12 degrees of tilt, Buoy fires up legs and hips, delivering an active working posture.

